

*

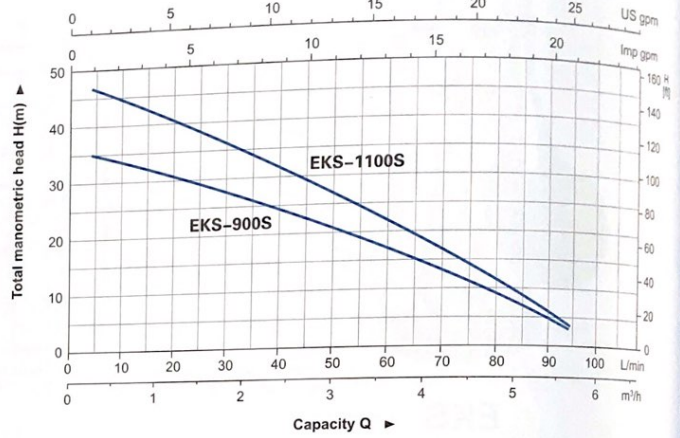

EKS

HYDRAULIC PERFORMANCE CURVE



APPLICATIONS

- Mainly used for use in traditional wells, water deposits and collection tanks.
- Suitable for small scale irrigation systems

MOTOR

- Both copper and aluminum winding available
- Built-in thermal protector
- Insulation class: F
- Protection class: IPX8

PUMP

- Stainless steel pump body
- High lift with multistage-impeller design
- Max. liquid temperature: +35°C
- Max. immersion depth: 5 m
- Max. particle diameter: 1 mm

MODEL	RATED POWER (W)	OUTLET (mm)	MAX.FLOW (m³/h)	MAX.HEAD (m)	MAX. IMMERSION (m)
EKS-900S	900	25	6	36	3
EKS-1100S	1100	25	6	48	4

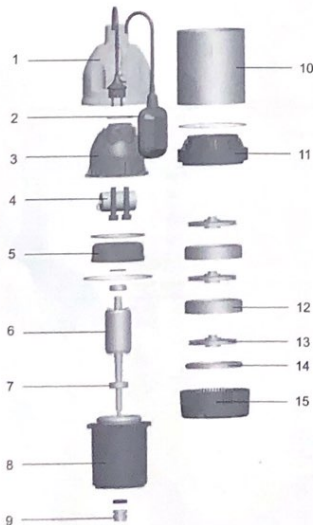

Part	
1	Pump body
2	Float switch
3	Upper cover
4	Capacitor
5	Upper plate
6	Rotor
7	Bearing
8	Stator
9	Mechanical seal
10	Pump body
11	Diffuser
12	Diffuser
13	Impeller
14	Pump cover
15	Base